

SMA SERIES ADAPTERS

Double SMA male
S-311 (50Ω)

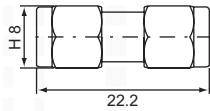

Double SMA female
S-322 (50Ω)

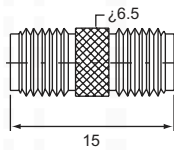

double SMA male right angle
S-411 (50Ω)

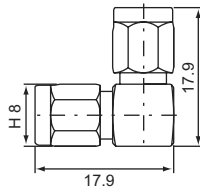

double SMA female right angle
S-422 (50Ω)

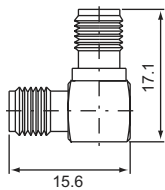

three SMA female T-type
S-522 (50Ω)

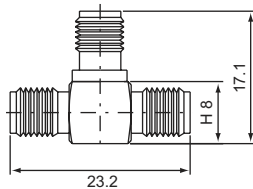

SMA male-BNC female
SB-312 (50Ω)

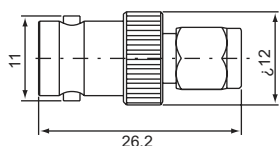

SMA male-SMA female
S-312 (50Ω)

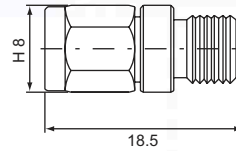

double SMA female bulkhead receptacle
S-332-WP (50Ω)

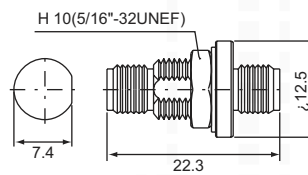

SMA male-SMA female right angle
S-412 (50Ω)

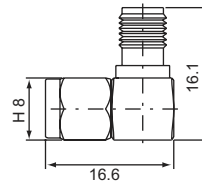

single SMA male double SMA female T-type
S-512 (50Ω)

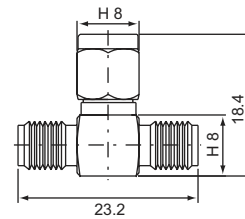

SMA male-BNC male
SB-311 (50Ω)

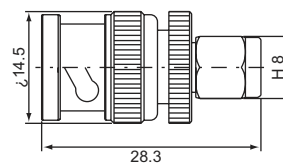

SMA female-BNC male
SB-321 (50Ω)

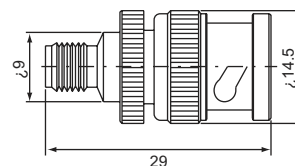

SMA female-BNC female
SB-322 (50Ω)

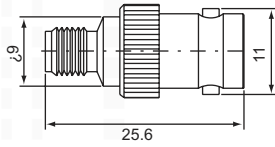

SMA male-mini UHF male
SM-311 (50Ω)

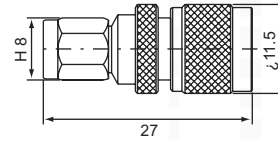

SMA male-mini UHF female
SM-312 (50Ω)

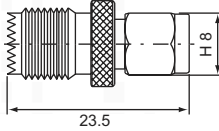

SMA female-mini UHF male
SM-321 (50Ω)

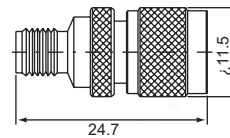

SMA female-mini UHF female
SM-322 (50Ω)

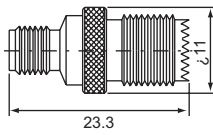

SMA male-N male
SN-311 (50Ω)

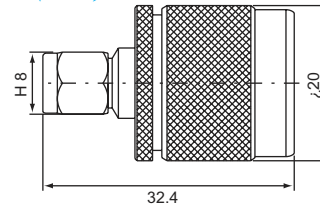

SMA male-N female
SN-312 (50Ω)

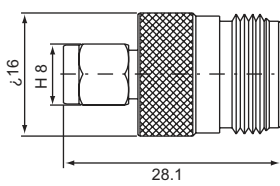

SMA female-N male
SN-321 (50Ω)

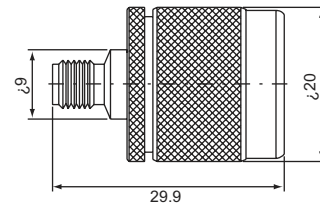

SMA female-N female
SN-322 (50Ω)

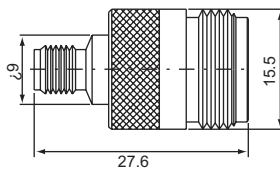

SMA male-TNC male
ST-311 (50Ω)

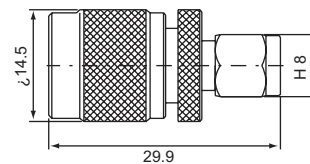

SMA male-TNC female
ST-312 (50Ω)

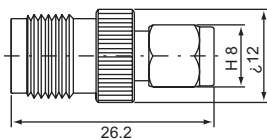

SMA female-TNC male
ST-321 (50Ω)

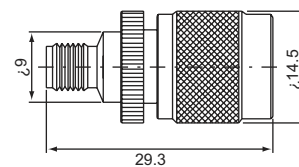

SMA female-TNC female
ST-322 (50Ω)

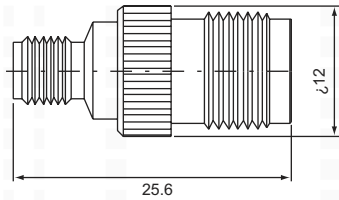

SMA male-UHF male
SU-311 (50Ω)

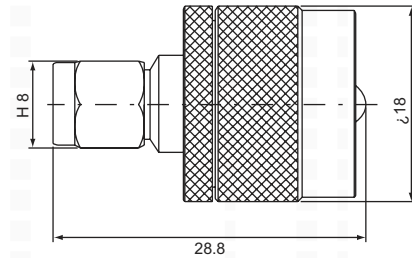

SMA male-UHF female
SU-312 (50Ω)

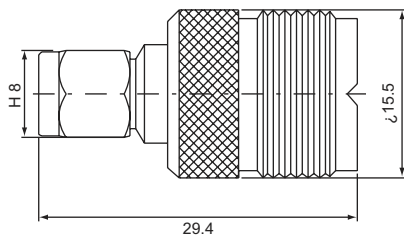

SMA female-UHF male
SU-321 (50Ω)

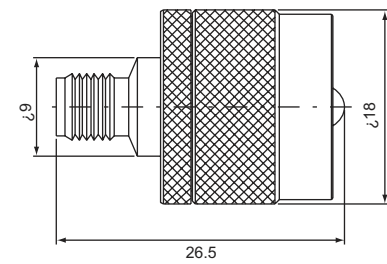

SMA female-UHF female
SU-322 (50Ω)

