

# SOLDERLESS CABLE CONNECTORS

**BNC MALE**

**B-C111F** (50Ω,75Ω)

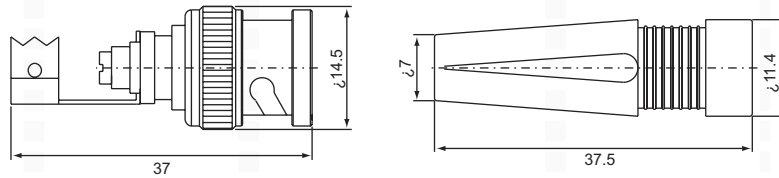

**BNC FEMALE**

**B-C211F** (50Ω,75Ω)

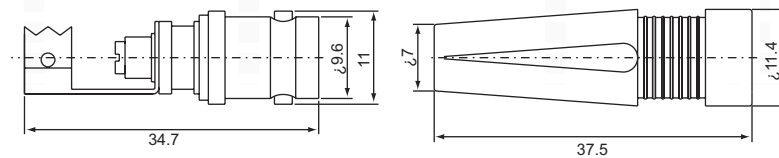

**BNC MALE, Right angle**

**B-C411F** (50Ω,75Ω)

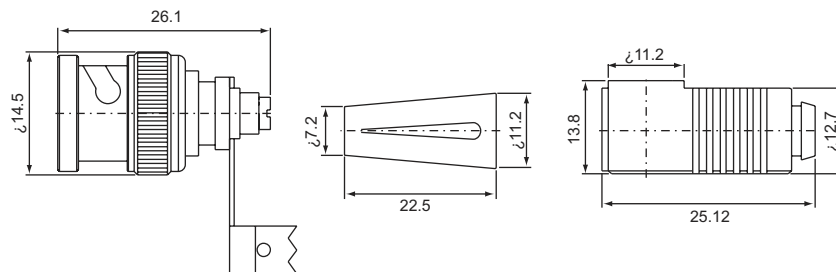

**F MALE**

**F-C111** (50Ω,75Ω)

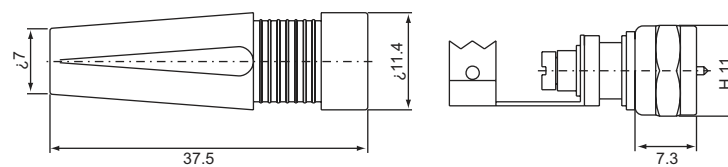

**F MALE, Right angle**

**F-C411** (50Ω,75Ω)

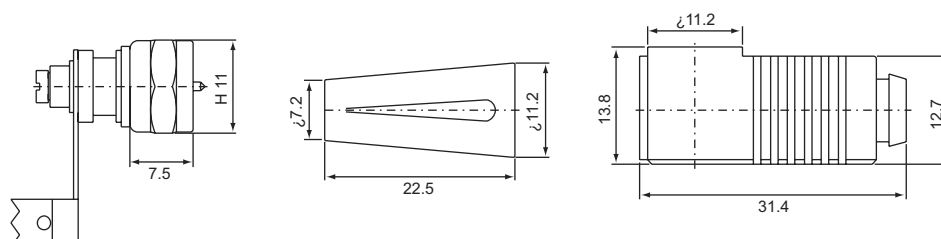

**RCA MALE**  
**R-C111 (50Ω,75Ω)**

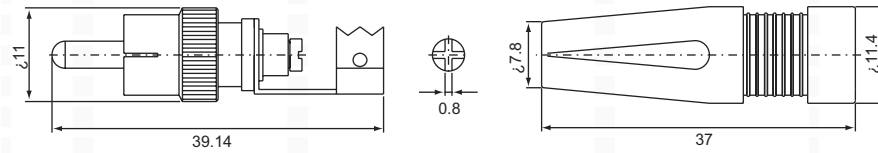

**SMA right angle adaptor**  
**S-C411F (50Ω,75Ω)**

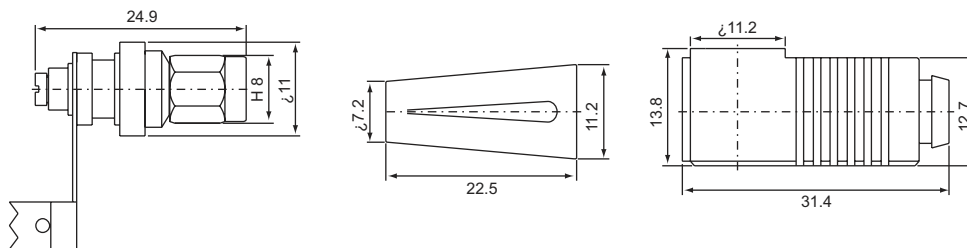

**UHF MALE, Crimp type**  
**U-C111 (50Ω,75Ω)**

